

Sweffling Parish Council
Land Asset - Jubilee Field

Behind Blyth Villas adjacent to Jubilee Close

Holden's Lane, Sweffling, East Suffolk

Post Code: IP17 2BP

What3words: perfume.pimples.bonfires. (Gate to field)

GridRef : TM345637

Description: Area of land around 0.8 acres to the south of Holden's Lane Sweffling behind Blyth Villas that was bought from Suffolk Coastal District Council in March 2011 to be used for a village amenity for £1.

A survey of the village at the time rejected using the land for allotments - not enough support and no water available.

The Parish Council decided to use the land for the enjoyment of local villagers to include a children's play area; picnic tables and other seating; and the possibility of a community orchard.

The building of 4 Homes by Orwell Housing in 2014/2015 enabled SPC to clear the site of blackthorn roots and suckers; level the ground and fence and hedge the field at the entrance through Jubilee Close - payback from Orwell Housing for using our land as a carpark.

Old swings were removed, new ones acquired and a climbing trail added in 2015/16. Local sports trainers suggested we put in adult training equipment in 2016 and this has recently been added to in 2021/22.

Present use is for the enjoyment of all villagers, their families and local walkers. The play equipment is well maintained and a regular grass cutting regime is in place. Currently SPC have been advised by Suffolk Wildlife Trust as to how to improve the insect life on the field and areas are being managed for wildlife.

Up-dated June 2023.....*Amanda S. Jenner*.....signed
29/06/2023

CURRENT SPORTS/PLAY FACILITIES AT SWEFFLING

JUBILEE FIELD as at JUNE 2016

Land Registry
Official copy of
title plan

Title number **SK330198**

Ordnance Survey map reference **TM3463NE**

Scale **1:1250** enlarged from 1:2500

Administrative area **Suffolk: Suffolk Coastal**

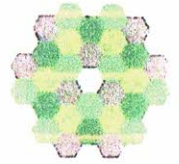

© Crown Copyright. Produced by Land Registry. Reproduction in whole or in part is prohibited without the prior written permission of Ordnance Survey. Licence Number 100026316.

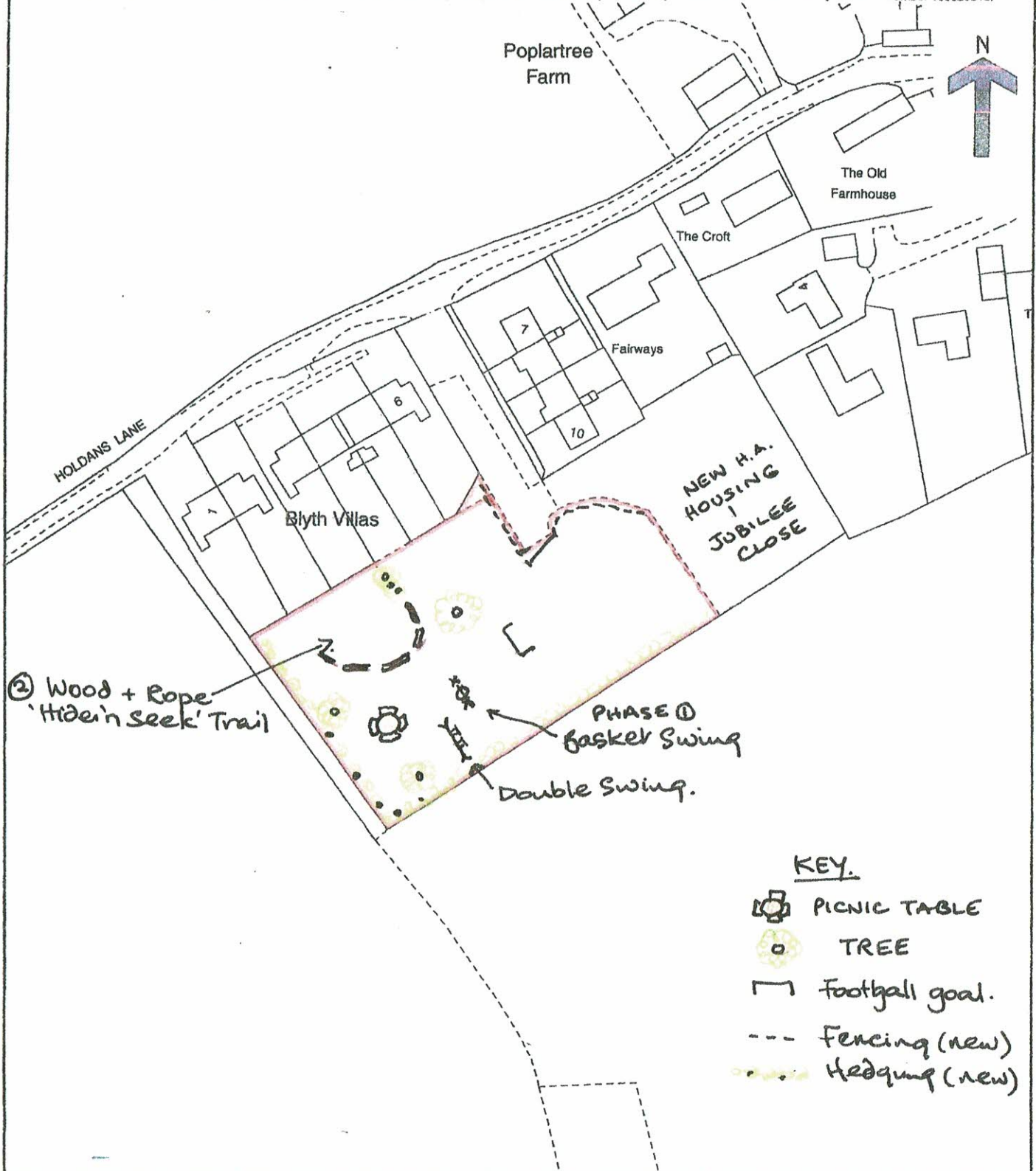

KEY.



PICNIC TABLE



TREE



Football goal.



Fencing (new)



Hedging (new)

This official copy issued on 29 March 2011 shows the state of this title plan on 29 March 2011 at 10:29:34. It is admissible in evidence to the same extent as the original (s.67 Land Registration Act 2002).

This title plan shows the general position, not the exact line, of the boundaries. It may be subject to distortions in scale. Measurements scaled from this plan may not match measurements between the same points on the ground. See Land Registry Public Guide 19 - Title Plans and Boundaries.

This title is dealt with by Land Registry, Kingston upon Hull Office.

Google Maps IP17 2BP



Imagery ©2023 CNES / Airbus, Getmapping plc, Infoterra Ltd & Bluesky, Maxar Technologies, Map data ©2023 20 m